

STANDARD TERMS



SAMPLE COMPUTATION
Standard Payment Term 2024

Unit:	Queen Suite / Twin Suite
Area:	24.0 sqm
Unit Cost:	8,120,000.00
Fit-out Cost:	2,280,000.00
Total Contract Price:	10,400,000.00

CASH TERM

Unit Cost:	8,120,000.00	
<i>Less Discount:</i>	<i>1,015,000.00</i>	12.5%
	7,105,000.00	
<i>Less Reservation:</i>	<i>30,000.00</i>	
Net Unit Cost:	7,075,000.00	
Add: Fit-out Cost:	2,280,000.00	
Total Contract Price:	9,355,000.00	

<i>Less: PDC Discount:</i>	3%	243,600.00
<i>Less: Special Discount:</i>	2%	157,528.00
Net Unit Cost:		7,718,872.00
Add: Fit-out Cost:		2,280,000.00
Total Contract Price:		9,998,872.00

OPTION 2

10% Down Payment	771,887.20
<i>Less Reservation Fee:</i>	<i>30,000.00</i>
Net Down Payment	741,887.20
10% Monthly Amortization	771,887.20
<i>payable in 24 months:</i>	<i>32,161.97</i>
80% Balance Upon Turnover	6,175,097.60
Add: Fit-out cost	2,280,000.00
Balance Payable on the 25th month	8,455,097.60
<i>(including Fit-out cost)</i>	

NOTE: Kindly make all checks payable to MEGAWORLD CORP. The reservation fee and/or initial monthly fee is non refundable in case of cancellation or withdrawal by the buyer. Price as of **MAY 2024**. Changes in prices will be disseminated.

1.) **Reservation Fee: Php 30,000.00**

2.) **Discount applicable:**

- Can be granted if complete post dated checks are submitted to Megaworld – Treasury **within 15 days from reservation date**. Applicable to all terms with Monthly Amortization (Not applicable to cash term and terms without Monthly Amortization). PDC discount is automatically forfeited if at least one of the cheques submitted has bounced or is replaced.

3.) Megaworld Corp. reserves the right to correct any error that may appear on this computation.



BELMONT HOTEL ILOILO

QUEEN SUITE

24.00 SQM.

3RD FLOOR = UNITS 3002, 3004, 3006, 3007, 3010, 3011

3A FLOOR = UNITS 3A01, 3A02, 3A05, 3A06, 3A09, 3A10, 3A12, 3A15, 3A17, 3A18, 3A22, 3A26, 3A30

5TH FLOOR = UNITS 5005, 5008, 5009, 5011, 5014, 5015, 5018, 5019, 5022, 5023, 5025, 5027, 5029, 5030, 5034, 5038, 5042

6TH FLOOR = UNITS 6005, 6008, 6009, 6011, 6014, 6015, 6018, 6019, 6022, 6023, 6025, 6027, 6029, 6030, 6034, 6038, 6042

7TH FLOOR = UNITS 7005, 7008, 7009, 7011, 7014, 7015, 7018, 7019, 7022, 7023, 7025, 7027, 7029, 7030, 7034, 7038, 7042

8TH FLOOR = UNITS 8005, 8008, 8009, 8011, 8014, 8015, 8018, 8019, 8022, 8023, 8025, 8027, 8029, 8030, 8034, 8038, 8042

9TH FLOOR = UNITS 9005, 9008, 9009, 9011, 9014, 9015, 9018, 9019, 9022, 9023, 9025, 9027, 9029, 9030, 9034, 9038, 9042

10TH FLOOR = UNITS 1005, 1008, 1009, 1011, 1014, 1015, 1018, 1019, 1022, 1023, 1025, 1027, 1029, 1030, 1034, 1038, 1042

11TH FLOOR = UNITS 1105, 1108, 1109, 1112, 1115, 1116, 1119, 1120, 1122, 1124, 1126, 1131, 1136, 1140

12TH FLOOR = UNITS 1205, 1208, 1209, 1212, 1215, 1216, 1219, 1220, 1222, 1224, 1226, 1231, 1236, 1240

All units are furnished with the furniture and appliances completely listed in the Fit-Out Agreement. Any other furniture, fixture, ornament or detail that may be reflected in the plans has been indicated therein for illustration purposes only and is not included in the sale. The selling price is established principally on a per unit basis and not on the basis of unit measurement or dimension. Sizes and location of structural elements and utility pipe chases are subject to change and may differ from actual deliverable condition.



BELMONT HOTEL ILOILO

TWIN SUITE 24.00 SQM.

3RD FLOOR = UNITS 3001, 3003, 3005, 3008, 3009

3A FLOOR = UNITS 3A03, 3A04, 3A07, 3A08, 3A11, 3A14, 3A16, 3A19, 3A20, 3A21, 3A23, 3A24, 3A25, 3A27, 3A28, 3A29, 3A31, 3A32, 3A33, 3A35

5TH FLOOR = UNITS 5006, 5007, 5010, 5012, 5016, 5017, 5020, 5021, 5024, 5026, 5028, 5031, 5032, 5033, 5035, 5036, 5037, 5039, 5040, 5041, 5043, 5045, 5046, 5047

6TH FLOOR = UNITS 6006, 6007, 6010, 6012, 6016, 6017, 6020, 6021, 6024, 6026, 6028, 6031, 6032, 6033, 6035, 6036, 6037, 6039, 6040, 6041, 6043, 6045, 6046, 6047

7TH FLOOR = UNITS 7006, 7007, 7010, 7012, 7016, 7017, 7020, 7021, 7024, 7026, 7028, 7031, 7032, 7033, 7035, 7036, 7037, 7039, 7040, 7041, 7043, 7045, 7046, 7047

8TH FLOOR = UNITS 8006, 8007, 8010, 8012, 8016, 8017, 8020, 8021, 8024, 8026, 8028, 8031, 8032, 8033, 8035, 8036, 8037, 8039, 8040, 8041, 8043, 8045, 8046, 8047

9TH FLOOR = UNITS 9006, 9007, 9010, 9012, 9016, 9017, 9020, 9021, 9024, 9026, 9028, 9031, 9032, 9033, 9035, 9036, 9037, 9039, 9040, 9041, 9043, 9045, 9046, 9047

10TH FLOOR = UNITS 1006, 1007, 1010, 1012, 1016, 1017, 1020, 1021, 1024, 1026, 1028, 1031, 1032, 1033, 1035, 1036, 1037, 1039, 1040, 1041, 1043, 1045, 1046, 1047

11TH FLOOR = UNITS 1106, 1110, 1114, 1117, 1118, 1121, 1123, 1125, 1128, 1129, 1130, 1132, 1133, 1135, 1137, 1138, 1139, 1141, 1143

12TH FLOOR = UNITS 1206, 1210, 1214, 1217, 1218, 1221, 1223, 1225, 1228, 1229, 1230, 1232, 1233, 1235, 1237, 1238, 1239, 1241, 1243

All units are furnished with the furniture and appliances completely listed in the Fit-Out Agreement. Any other furniture, fixture, ornament or detail that may be reflected in the plans has been indicated therein for illustration purposes only and is not included in the sale. The selling price is established principally on a per unit basis and not on the basis of unit measurement or dimension. Sizes and location of structural elements and utility pipe chases are subject to change and may differ from actual deliverable condition.

STANDARD TERMS

BELMONT HOTEL ILOILO

SAMPLE COMPUTATION
Standard Payment Term 2023

Unit:	JUNIOR SUITE
Area:	31.0 sqm
Unit Cost:	10,490,400.00
Fit-out Cost:	2,929,600.00
Total Contract Price:	13,420,000.00

CASH TERM

Unit Cost:	10,490,400.00	
Less Discount:	1,311,300.00	12.5%
	9,179,100.00	
Less Reservation:	30,000.00	
Net Unit Cost:	9,149,100.00	
Add: Fit-out Cost:	2,929,600.00	
Total Contract Price:	12,078,700.00	

Less: PDC Discount:	3%	314,712.00
Less: Special Discount:	2%	203,513.76
Net Unit Cost:		9,972,174.24
Add: Fit-out Cost:		2,929,600.00
Total Contract Price:		12,901,774.24

OPTION 2

10% Down Payment	997,217.42
Less Reservation Fee:	30,000.00
Net Down Payment	967,217.42
10% Monthly Amortization	997,217.42
payable in <u>25</u> months:	39,888.70
80% Balance Upon Turnover	7,977,739.39
Add: Fit-out cost	2,929,600.00
Balance Payable on July 31, 2024 (including Fit-out cost)	10,907,339.39

NOTE: Kindly make all checks payable to MEGAWORLD CORP. The reservation fee and/or initial monthly fee is non refundable in case of cancellation or withdrawal by the buyer. Price as of **SEPTEMBER 2023**. Changes in prices will be disseminated.

TURN OVER DATE: JULY 31, 2024

1.) Reservation Fee: Php 30,000.00

2.) Discount applicable:

- Can be granted if complete post dated checks are submitted to Megaworld – Treasury **within 15 days from reservation date**. Applicable to all terms with Monthly Amortization (Not applicable to cash term and terms without Monthly Amortization). PDC discount is automatically forfeited if at least one of the cheques submitted has bounced or is replaced.

3.) Regardless of the above promo term, all payments will end on **JULY 31, 2024**, and all monthly amortization and lumpsum beyond the said date will be added to the Balance Upon Turnover. All outstanding balances will be due and demandable on **JULY 31, 2024**.

4.) Megaworld Corp. reserves the right to correct any error that may appear on this computation.

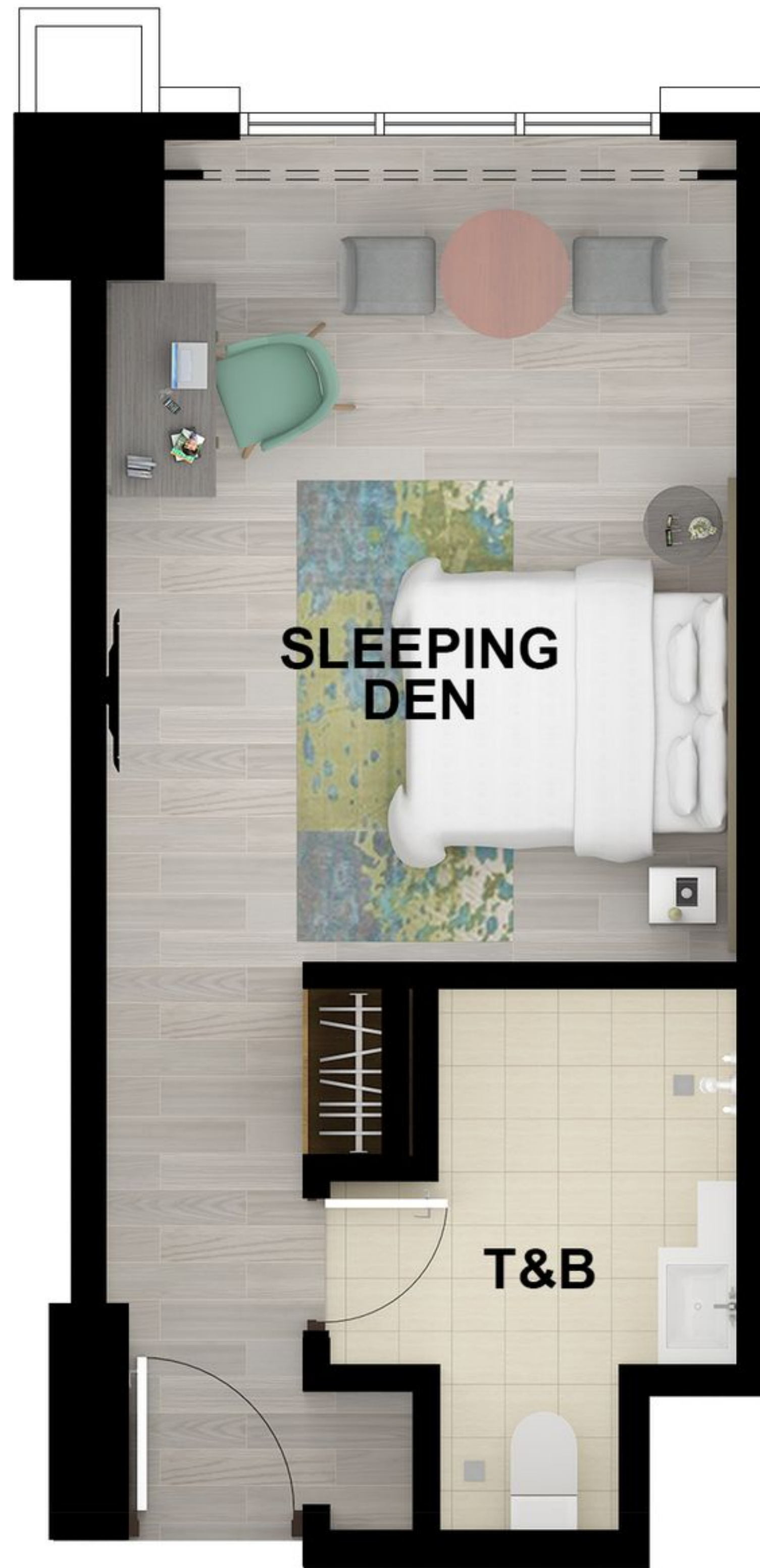

BELMONT HOTEL ILOILO

JUNIOR SUITE

31.00 SQM.

5TH FLOOR = UNITS 5003
6TH FLOOR = UNITS 6003
7TH FLOOR = UNITS 7003
8TH FLOOR = UNITS 8003
9TH FLOOR = UNITS 9003
10TH FLOOR = UNITS 1003
11TH FLOOR = UNITS 1103
12TH FLOOR = UNITS 1203

All units are furnished with the furniture and appliances completely listed in the Fit-Out Agreement. Any other furniture, fixture, ornament or detail that may be reflected in the plans has been indicated therein for illustration purposes only and is not included in the sale. The selling price is established principally on a per unit basis and not on the basis of unit measurement or dimension. Sizes and location of structural elements and utility pipe chases are subject to change and may differ from actual deliverable condition.

STANDARD TERMS

BELMONT
HOTEL ILOILO

SAMPLE COMPUTATION
Standard Payment Term 2023

Unit:	Specially Abled Suite
Area:	30.0 sqm
Unit Cost:	10,153,200.00
Fit-out Cost:	2,836,800.00
Total Contract Price:	12,990,000.00

CASH TERM

Unit Cost:	10,153,200.00	
Less Discount:	1,269,150.00	12.5%
	8,884,050.00	
Less Reservation:	30,000.00	
Net Unit Cost:	8,854,050.00	
Add: Fit-out Cost:	2,836,800.00	
Total Contract Price:	11,690,850.00	

Less: PDC Discount:	3%	304,596.00
Less: Special Discount:	2%	196,972.08
Net Unit Cost:		9,651,631.92
Add: Fit-out Cost:		2,836,800.00
Total Contract Price:		12,488,431.92

OPTION 2

10% Down Payment	965,163.19
Less Reservation Fee:	30,000.00
Net Down Payment	935,163.19
10% Monthly Amortization	965,163.19
payable in 25 months:	38,606.53
80% Balance Upon Turnover	7,721,305.54
Add: Fit-out cost	2,836,800.00
Balance Payable on July 31, 2024 (including Fit-out cost)	10,558,105.54

NOTE: Kindly make all checks payable to MEGAWORLD CORP. The reservation fee and/or initial monthly fee is non refundable in case of cancellation or withdrawal by the buyer. Price as of **SEPTEMBER 2023**. Changes in prices will be disseminated.

TURN OVER DATE: **JULY 31, 2024**

1.) Reservation Fee: Php 30,000.00

2.) Discount applicable:

- Can be granted if complete post dated checks are submitted to Megaworld – Treasury **within 15 days from reservation date**. Applicable to all terms with Monthly Amortization (Not applicable to cash term and terms without Monthly Amortization). PDC discount is automatically forfeited if at least one of the cheques submitted has bounced or is replaced.

3.) Regardless of the above promo term, all payments will end on **JULY 31, 2024**, and all monthly amortization and lumpsum beyond the said date will be added to the Balance Upon Turnover. All outstanding balances will be due and demandable on **JULY 31, 2024**.

4.) Megaworld Corp. reserves the right to correct any error that may appear on this computation.



BELMONT HOTEL ILOILO

SPECIALLY-ABLED SUITE **30.00 SQM.**

5TH FLOOR = UNITS 5004
6TH FLOOR = UNITS 6004
7TH FLOOR = UNITS 7004
8TH FLOOR = UNITS 8004
9TH FLOOR = UNITS 9004
10TH FLOOR = UNITS 1004
11TH FLOOR = UNITS 1104
12TH FLOOR = UNITS 1204

All units are furnished with the furniture and appliances completely listed in the Fit-Out Agreement. Any other furniture, fixture, ornament or detail that may be reflected in the plans has been indicated therein for illustration purposes only and is not included in the sale. The selling price is established principally on a per unit basis and not on the basis of unit measurement or dimension. Sizes and location of structural elements and utility pipe chases are subject to change and may differ from actual deliverable condition.

STANDARD TERMS



SAMPLE COMPUTATION
Standard Payment Term 2023

Unit:	Executive Suite
Area:	52.0 sqm
Unit Cost:	19,280,560.00
Fit-out Cost:	3,189,440.00
Total Contract Price:	22,470,000.00

CASH TERM

Unit Cost:	19,280,560.00	
Less Discount:	2,410,070.00	12.5%
	16,870,490.00	
Less Reservation:	30,000.00	
Net Unit Cost:	16,840,490.00	
Add: Fit-out Cost:	3,189,440.00	
Total Contract Price:	20,029,930.00	

Less: PDC Discount:	3%	578,416.80
Less: Special Discount:	2%	374,042.86
Net Unit Cost:		18,328,100.34
Add: Fit-out Cost:		3,189,440.00
Total Contract Price:		21,517,540.34

OPTION 2

10% Down Payment	1,832,810.03
Less Reservation Fee:	30,000.00
Net Down Payment	1,802,810.03
10% Monthly Amortization	1,832,810.03
payable in 24 months:	76,367.08
Balance Payable on July 31, 2024 (including Fit-out cost)	17,851,920.27

NOTE: Kindly make all checks payable to MEGAWORLD CORP. The reservation fee and/or initial monthly fee is non refundable in case of cancellation or withdrawal by the buyer. Price as of MARCH 2023. Changes in prices will be disseminated.

TURN OVER DATE: JULY 31, 2024

1.) Reservation Fee: Php 30,000.00

2.) Discount applicable:

- Can be granted if complete post dated checks are submitted to Megaworld – Treasury within 15 days from reservation date. Applicable to all terms with Monthly Amortization (Not applicable to cash term and terms without Monthly Amortization). PDC discount is automatically forfeited if at least one of the cheques submitted has bounced or is replaced.

3.) Regardless of the above promo term, all payments will end on JULY 31, 2024, and all monthly amortization and lumpsum beyond the said date will be added to the Balance Upon Turnover. All outstanding balances will be due and demandable on JULY 31, 2024.

4.) Megaworld Corp. reserves the right to correct any error that may appear on this computation.



BELMONT HOTEL ILOILO

EXECUTIVE SUITE 52.00 SQM.

3A FLOOR = UNITS 3A34
5TH FLOOR = UNITS 5002, 5048
6TH FLOOR = UNITS 6002, 6048
7TH FLOOR = UNITS 7002, 7048
8TH FLOOR = UNITS 8002, 8048
9TH FLOOR = UNITS 9002, 9048
10TH FLOOR = UNITS 1002, 1048
11TH FLOOR = UNITS 1102, 1142
12TH FLOOR = UNITS 1202, 1242

All units are furnished with the furniture and appliances completely listed in the Fit-Out Agreement. Any other furniture, fixture, ornament or detail that may be reflected in the plans has been indicated therein for illustration purposes only and is not included in the sale. The selling price is established principally on a per unit basis and not on the basis of unit measurement or dimension. Sizes and location of structural elements and utility pipe chases are subject to change and may differ from actual deliverable condition.

STANDARD TERMS

BELMONT HOTEL ILOILO

SAMPLE COMPUTATION
Standard Payment Term 2023

Unit:	Executive Suite
Area:	53.0 sqm
Unit Cost:	19,660,240.00
Fit-out Cost:	3,249,760.00
Total Contract Price:	22,910,000.00

CASH TERM

Unit Cost:	19,660,240.00	
Less Discount:	2,457,530.00	12.5%
	17,202,710.00	
Less Reservation:	30,000.00	
Net Unit Cost:	17,172,710.00	
Add: Fit-out Cost:	3,249,760.00	
Total Contract Price:	20,422,470.00	

Less: PDC Discount:	3%	589,807.20
Less: Special Discount:	2%	381,408.66
Net Unit Cost:		18,689,024.14
Add: Fit-out Cost:		3,249,760.00
Total Contract Price:		21,938,784.14

OPTION 2

10% Down Payment	1,868,902.41
Less Reservation Fee:	30,000.00
Net Down Payment	1,838,902.41
10% Monthly Amortization	1,868,902.41
payable in 24 months:	77,870.93
Balance Payable on July 31, 2024 (including Fit-out cost)	18,200,979.32

NOTE: Kindly make all checks payable to MEGAWORLD CORP. The reservation fee and/or initial monthly fee is non refundable in case of cancellation or withdrawal by the buyer. Price as of MARCH 2023. Changes in prices will be disseminated.

TURN OVER DATE: JULY 31, 2024

1.) Reservation Fee: Php 30,000.00

2.) Discount applicable:

- Can be granted if complete post dated checks are submitted to Megaworld – Treasury **within 15 days from reservation date**. Applicable to all terms with Monthly Amortization (Not applicable to cash term and terms without Monthly Amortization). PDC discount is automatically forfeited if at least one of the cheques submitted has bounced or is replaced.

3.) Regardless of the above promo term, all payments will end on **JULY 31, 2024**, and all monthly amortization and lumpsum beyond the said date will be added to the Balance Upon Turnover. All outstanding balances will be due and demandable on **JULY 31, 2024**.

4.) Megaworld Corp. reserves the right to correct any error that may appear on this computation.



BELMONT HOTEL

ILOILO

EXECUTIVE SUITE

53.00 SQM.

- 5TH FLOOR = UNITS 5001
- 6TH FLOOR = UNITS 6001
- 7TH FLOOR = UNITS 7001
- 8TH FLOOR = UNITS 8001
- 9TH FLOOR = UNITS 9001
- 10TH FLOOR = UNITS 1001
- 11TH FLOOR = UNITS 1101
- 12TH FLOOR = UNITS 1201

All units are furnished with the furniture and appliances completely listed in the Fit-Out Agreement. Any other furniture, fixture, ornament or detail that may be reflected in the plans has been indicated therein for illustration purposes only and is not included in the sale. The selling price is established principally on a per unit basis and not on the basis of unit measurement or dimension. Sizes and location of structural elements and utility pipe chases are subject to change and may differ from actual deliverable condition.



BELMONT HOTEL

ILOILO

TYPICAL 6TH TO 10TH FLOOR PLAN



All units are furnished with the furniture and appliances completely listed in the Fit-Out Agreement. Any other furniture, fixture, ornament or detail that may be reflected in the plans has been indicated therein for illustration purposes only and is not included in the sale. The selling price is established principally on a per unit basis and not on the basis of unit measurement or dimension. Sizes and location of structural elements and utility pipe chases are subject to change and may differ from actual deliverable condition.



BELMONT HOTEL

ILOILO

3RD FLOOR PLAN



All units are furnished with the furniture and appliances completely listed in the Fit-Out Agreement. Any other furniture, fixture, ornament or detail that may be reflected in the plans has been indicated therein for illustration purposes only and is not included in the sale. The selling price is established principally on a per unit basis and not on the basis of unit measurement or dimension. Sizes and location of structural elements and utility pipe chases are subject to change and may differ from actual deliverable condition.



BELMONT HOTEL

ILOILO



3A AMENITY FLOOR PLAN

All units are furnished with the furniture and appliances completely listed in the Fit-Out Agreement. Any other furniture, fixture, ornament or detail that may be reflected in the plans has been indicated therein for illustration purposes only and is not included in the sale. The selling price is established principally on a per unit basis and not on the basis of unit measurement or dimension. Sizes and location of structural elements and utility pipe chases are subject to change and may differ from actual deliverable condition.